

1. UNLESS OTHERWISE SPECIFIED TOLERANCES ARE ±.010 (.254mm)

DRAWING NO. 12-0001 REV. C

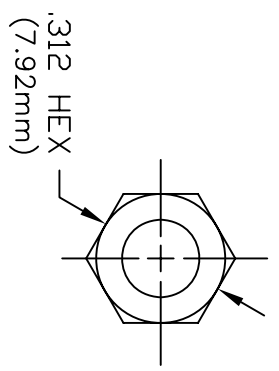
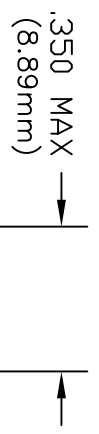

MATERIALS:  
 BODY & COUPLING NUT: S.S. PER ASTM A582  
 CONTACT: BERYLLIUM COPPER PER ASTM B196  
 RESISTIVE FILM: NICHROME  
 FINISH:  
 BODY: GOLD PER MIL-G-45204  
 CONTACT: GOLD PER MIL-G-45204  
 COUPLING NUT: PASSIVATE PER QQ-P-35

REV.	DESCRIPTION	DATE	APPR.	UNLESS OTHERWISE SPECIFIED				REFERENCE	TITLE		
				1. DIMENSIONS ARE AFTER PLATING 2. DIAMETERS ON COMMON Q TO BE CONCENTRIC WITHIN T.I.R. 3. SURFACE ROUGHNESS 4. CORNERS AND EDGES R. MAX. 5. REMOVE BURRS AND BREAK SHARP EDGES					TERMININATION, COAXIAL SMA		
				DECIMAL TOLERANCES ANGLES .X ±      ±      ± .XX ±     ±      ± .XXX ±    ±      ± ALL DIMENSIONS ARE IN INCHES					P.O. BOX 899 STUART, FL. 34995		
				08-F1138 12/08 DCN#0464 10/96 DCN#0437 05/96 RLSE#02312 01/98 MTG					SCALE CAGE CODE ID NO. SIZE 2X 2Y194 A		
				UNLESS OTHERWISE SPECIFIED 1. DIMENSIONS ARE AFTER PLATING 2. DIAMETERS ON COMMON Q TO BE CONCENTRIC WITHIN T.I.R. 3. SURFACE ROUGHNESS 4. CORNERS AND EDGES R. MAX. 5. REMOVE BURRS AND BREAK SHARP EDGES					DRAWING NO. 12-0001 REV. C DRAWN/GEC 01/08/98 SHEET 1 OF 2		

DRAWING NO. 12-0001 REV. C

REQUIREMENTS	RATING	REQUIREMENTS	RATING
NOMINAL IMPEDANCE (OHMS)	50	VIBRATION	MIL-STD-202 METHOD 204 COND. D (20 G's)
FREQUENCY RANGE (GHZ)	DC TO 18.0	SHOCK	MIL-STD-202 METHOD 213 COND. I (100 G's)
TEMPERATURE COEFFICIENT	LESS THAN 200 PPM	TEMPERATURE SHOCK	MIL-STD-202 METHOD 107G COND. B (-65 TO +125° C)
OPERATING TEMPERATURE (°C)	-55 TO 125	BAROMETRIC PRESSURE	MIL-STD-202 METHOD 105 COND. C
VSWR (MAXIMUM)	1.15	INTERFACE DIMENSIONS	MIL-C-39012C SMA SERIES
AVERAGE POWER (WATTS)	1.0	TORQUE REQUIREMENT	MIL-D-39030 SMA SERIES 7-10 IN/LBS (PER PAIR)
DC RESISTANCE	50 Ohms ± 5%		
AVERAGE POWER DERATING			

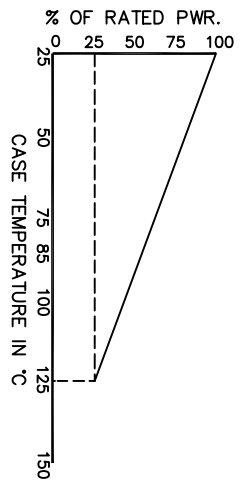

TITLE TERMINATION, COAXIAL SMA

FLORIDA R/F Labs INC. P.O. BOX 899 STUART, FL. 34995

DRAWN GEC SHEET 2 OF 2 DRAWING NO. 12-0001 REV. C